



**SAFE
HAVEN**

Percent for Art
ART WALK

SAFE HAVEN HEALTH AND WELLNESS ART COLLECTION

st. tammany parish
CCA
commission on cultural affairs

ART WALK MAP

ART WALK ROUTE

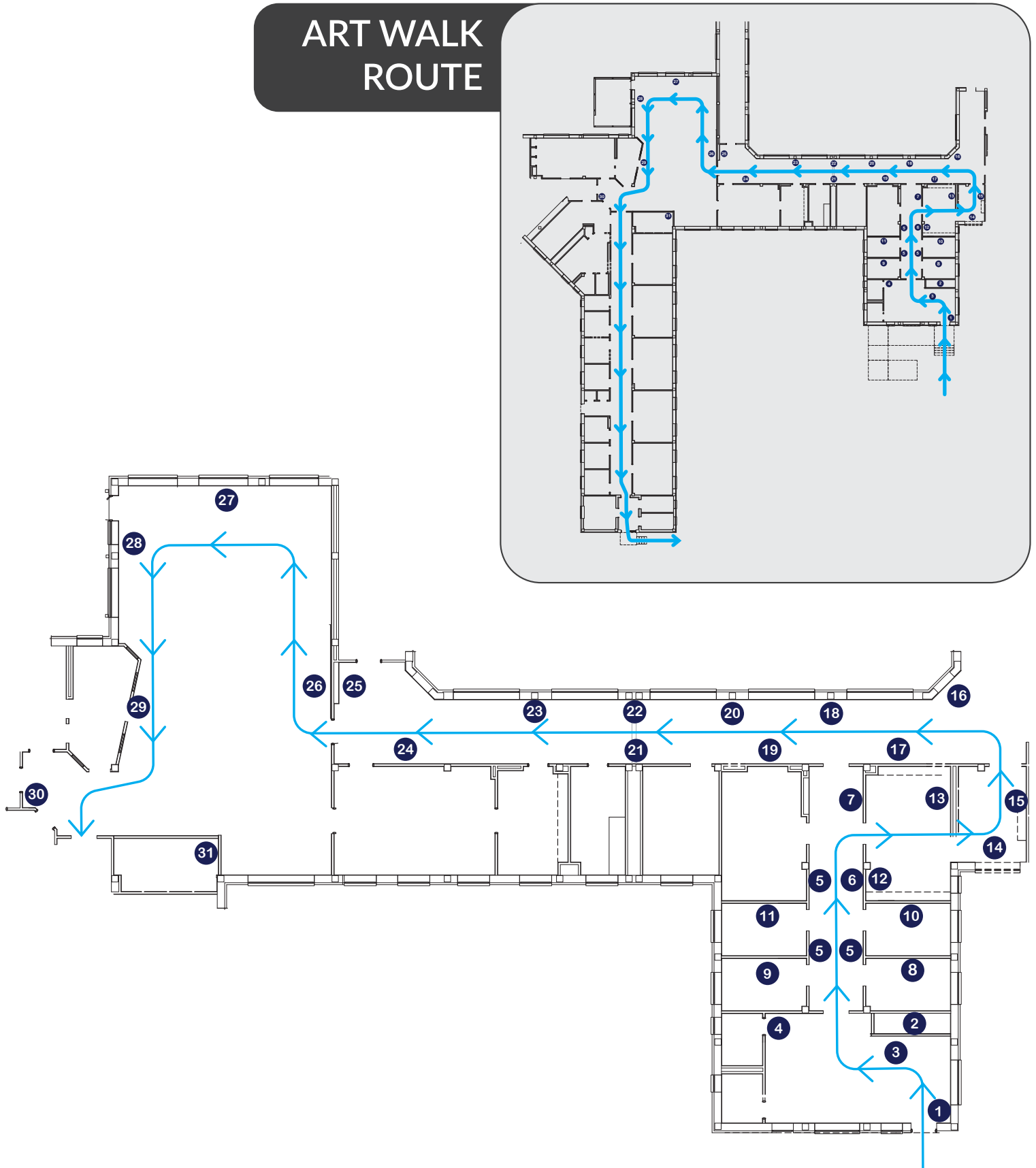

MAP LEGEND

WAITING ROOM

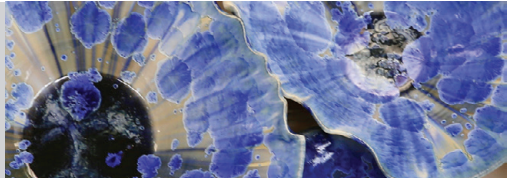
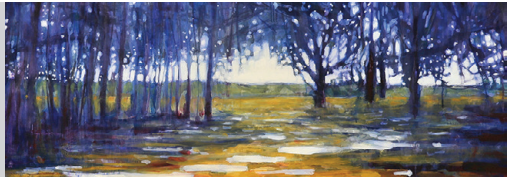
1	HEART 1 & 2 MEDIUM: CAST CONCRETE & TEXTURAL RELIEF ARTIST: MICHAEL EDDY	
2	SUMMERTIME SUNRISE MEDIUM: MIXED MEDIA ON CANVAS ARTIST: LORI SPERIER	
3	INDIGO MILK MEDIUM: CERAMIC STONEWARE ARTIST: CRAIG MCMILLIN <i>DONATED BY CARLOS SANCHEZ AND DAVID FENNELLY</i>	
4	TURN MEDIUM: OIL ON WOOD PANEL ARTIST: INGA CLOUGH FALTERMAN	

EXAM HALLWAY

5	WETLAND WATERWAYS SERIES MEDIUM: ACRYLIC ON CANVAS ARTIST: KATHY DUMESNIL	
6	BACK ROAD BEAUTY MEDIUM: ORIGINAL LITHOGRAPH ARTIST: ROLLAND GOLDEN	
7	FONTAINEBLEU WETLANDS MEDIUM: WATERCOLOR ARTIST: JAE LEVY	

MAP LEGEND

EXAM ROOMS





8	BLUE CRUSH MEDIUM: DIGITAL PHOTOGRAPH ON FINE ART PAPER ARTIST: NICHOLAS PECHON	
9	ORANGE TEAL MEDIUM: DIGITAL PHOTOGRAPH ON FINE ART PAPER ARTIST: NICHOLAS PECHON	
10	INFRARED SAND 2 MEDIUM: DIGITAL PHOTOGRAPH ON FINE ART PAPER ARTIST: NICHOLAS PECHON	
11	INFRARED SAND MEDIUM: DIGITAL PHOTOGRAPH ON FINE ART PAPER ARTIST: NICHOLAS PECHON	

LAW ENFORCEMENT OFFICE

12	LONESOME STREET SATSUMAS MEDIUM: PLEIN AIR OIL ON CANVAS ARTIST: BEN BENSEN III	
13	THE WOODS MEDIUM: OIL ON CANVAS ARTIST: MURIEL DAUTERIVE	
14	SEPTEMBER DUSK MEDIUM: DIGITAL PHOTOGRAPH ON FINE ART PAPER ARTIST: ELSA BAKER	
15	COLORADO SUMMER MEDIUM: ACRYLIC ON BOARD ARTIST: SUE ZAUNBRECHER	

MAP LEGEND

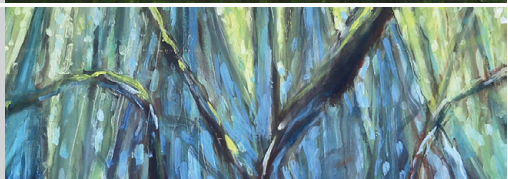
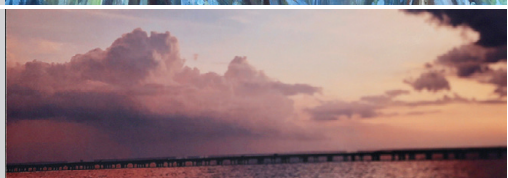
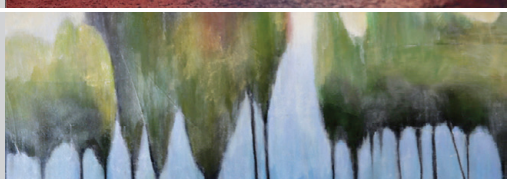
MAIN CORRIDOR

16	INLAND WATERS MEDIUM: ACRYLIC ON CANVAS ARTIST: CYNTHIA WEBB	
17	VIEWPOINT MEDIUM: ACRYLIC ON CANVAS ARTIST: CYNTHIA WEBB	
18	COMING HOME MEDIUM: ACRYLIC ON CANVAS ARTIST: SUE ZAUNBRECHER	
19	MINN MEDIUM: OIL ON WOOD PANEL ARTIST: INGA CLOUGH FALTERMAN	
20	DRAGONFLY PINK MEDIUM: DIGITAL PHOTOGRAPH ON ALUMINUM ARTIST: NICHOLAS PECHON	
21	GREEN TREESCAPE MEDIUM: ACRYLIC ON CANVAS ARTIST: LORI SPERIER	
22	OCTOBER 6, 2019 MEDIUM: DIGITAL PHOTOGRAPH ON ALUMINUM ARTIST: NICHOLAS PECHON	
23	AUGUST 17, 2020 MEDIUM: DIGITAL PHOTOGRAPH ON ALUMINUM ARTIST: NICHOLAS PECHON	

MAP LEGEND

MAIN CORRIDOR CONTINUED

24

NEEDLERUSH 1, 2, 3
MEDIUM: OIL ON WOOD PANEL

ARTIST: INGA CLOUGH FALTERMAN



25

CREPE MYRTLE WINTER
MEDIUM: WATERCOLOR

ARTIST: CYNTHIA WEBB



COMMON ROOM

26

MARSH EGRETS
MEDIUM: OIL ON CANVAS

ARTIST: JUDY NEWMAN



27

FIRST TO GREET THE DAY
MEDIUM: PLEIN AIR OIL ON CANVAS

ARTIST: BEN BENSON



28

PELICAN FLIGHT
MEDIUM: ACRYLIC AND OIL ON CANVAS

ARTIST: JUDY NEWMAN

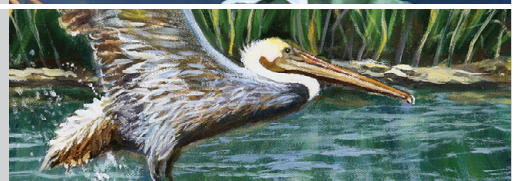

29

ICE CREAM CASTLES IN THE AIR
MEDIUM: GICLÉE ON CANVAS

ARTIST: CAROL HALLOCK



30

BACK BAYOU SUNRISE
MEDIUM: MIXED MEDIA ON CANVAS

ARTIST: AMY COUVILLION

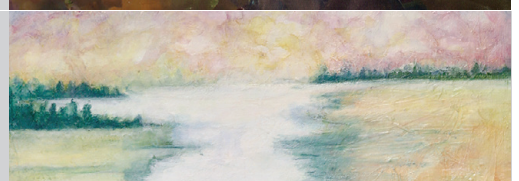

GROUP THERAPY

31

NO TITLE, MEDIUM: ACRYLIC ON CANVAS
ARTIST UNKNOWN

ARTIST: UNKNOWN
DONATED BY CARLOS SANCHEZ AND DAVID FENNELLY



ABOUT

PERCENT FOR ART FUNDING

In 2002, the Parish Council passed the 'Percent for Art' Ordinance. This ordinance authorizes the allocation of funds for art in the construction or renovation of public buildings. Over the years, public art has enabled people in all societies to better understand communities and individual lives. Through this ordinance, St. Tammany Parish Government and the Commission on Cultural Affairs accept a responsibility to expand the community's experience with visual art.

For this project, the selections were made to enhance the healing environment of the facility. Specifically, artwork that evokes nostalgia, a sense of comfort, or artwork that elicits positive feelings.

ART ADVISORY PANEL

- Cindy Pulling, Administrative Director for NAMI St. Tammany
- James Davis, District 7 Councilman
- Laura Prisco, Commission on Cultural Affairs
- Jennifer Bushnell, Commission on Cultural Affairs
- Mary D. Burckell, Director of Safe Haven

MORE INFORMATION



www.safehavenstp.org



safehaven@stpgov.org

MEDIA INQUIRIES



publicinfo@stpgov.org